

FEE RECOMMENDATION

For: McMillen Park Community Center

Cost Centers: 121-R320, 428-R320

Financial Objective and Justification Statement:

McMillen Park Community Center (MPCC) offers a wide variety of free youth programs including enrichment activities such as music, dance and STEM. It provides a safe gathering place for youth as well as many community groups. The MPCC was opened in May of 2014, and serves as a community resource with modest income goals as compared to its operational cost. The last fee proposal was on 6/9/2017

Proposal:

- Moderately increase fees to reflect increases in cost to the operation.
- Create a 428 (capital fund) to help pay for facility improvements
- Eliminate set fees for leagues, programs and special events. Instead, MPCC will use the Parks and Rec. costing form each quarter to establish programs and league fees.

Projected Results Outcome:

- We anticipate increases in revenue of \$1,000 and the ability to price programs utilizing established Parks and Recreation costing processes.

Competition:

- Spiece Fitness charges \$50 an hour per court Monday thru Friday from 9am-5pm. After 5pm. After 5pm Monday thru Friday the charge is \$70 per hour and weeks anytime are \$70 dollars.
- Parkview Sport One Fieldhouse charges \$55 an hour per court.
- YMCA's charges \$25 Member/\$50 non-member for one court. 2 courts \$50 Member/\$100 Non-member. Room rentals are \$50 Member/ \$75 Non-member

Attached:

- Fees and Charges
- Facility layout

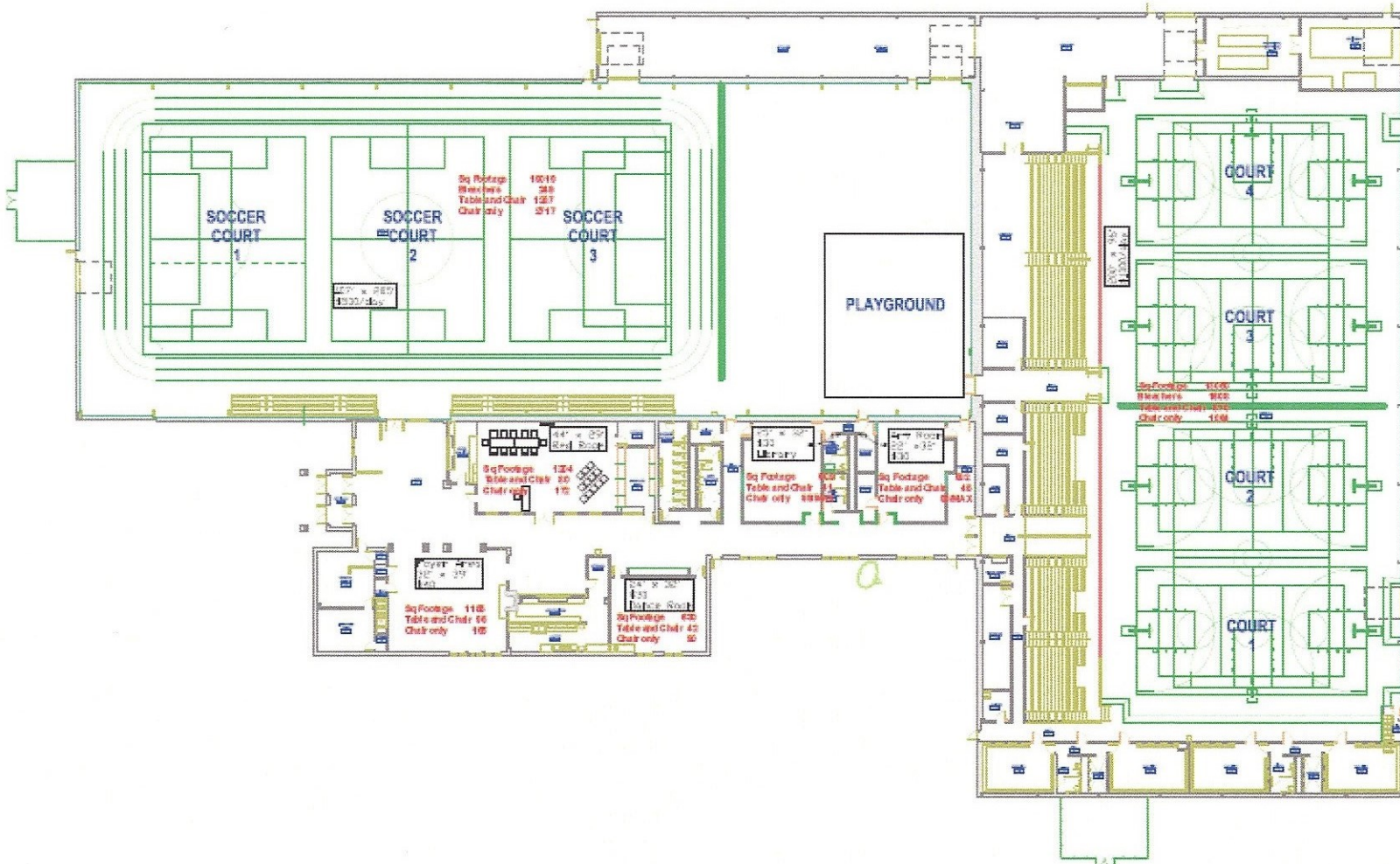

McMillen Park Community Center Fee Proposal

Multipurpose Room & Configuration					
		Effective 6/9/2017		Effective 4/15/2022	
Room	Capacity	Standard	per hour	Standard	per hour
Red Room/Room 122	172		\$40.00		\$50.00
Foyer	165		\$40.00		\$50.00
Library/Room 130	49		\$30.00		\$40.00
Art Room/Room 137	49		\$30.00		\$40.00
Dance Room/Room 119A	90		\$30.00		\$40.00
Arena # 1- Large Soccer Field	20		\$70.00		\$80.00
Arena #1 -Small Soccer Field	10		\$40.00		\$50.00
Arena # 2 - Courts 1-4	20		\$40.00		\$50.00
Arena # 2 - HS Court	30		\$70.00		\$80.00
Arena # 2 - College Court	40		\$70.00		\$80.00
Arena #2 -NBA Court	50		\$70.00		\$80.00
Arena # 1	2,717	\$500.00			\$85.00*
Arena # 2	1,864	\$1,000.00			\$170.00*
Additional Setup and clean up time per hour					Hourly Rate for Room
Additional party time per hour (maximum 2 hours)		\$60.00			\$70.00
Arena #1-Set up/Clean up time					\$70.00
Arena #1-Event Time					\$85.00
Arena #2-Set up/Clean up Tme					\$80.00
Arena #2- Event Time					\$170.00
McMillen Kids Korner	50	\$1.00 per adult/child	\$40.00	\$1.00 per adult/child	\$50.00
Additional Fees					
Alcohol Usage Fee		\$25.00		NA	
Returnable Cleaning Fee		\$25/\$100.00		\$50/100	
Security			\$35.00		\$55.00 or Market Rate
Shot Clock		\$25.00		\$35.00	n/a
Cordless Microphone		\$25.00		\$35.00	n/a
Bleachers (21 ft.)		\$50.00		\$60.00	n/a
Bleachers (12ft)		\$25.00		\$35.00	n/a
Bleachers (7ft)		\$15.00		\$25.00	n/a
Carpet (Whole Floor)		\$100.00		\$110.00	n/a
Carpet (Half Floor)		\$50.00		\$60.00	n/a
Team Fee		\$50.00		NA	Use Costing Forms
Youth Team Tournament Fee		\$150.00		NA	Use Costing Forms
Adult Team Tournament Fee		\$250.00		NA	Use Costing Forms

Special fees may be negotiated with approval from the Deputy Director of Recreation Services

8% of each rental will go into a non-reverting capital improvement fund

***Arena 1 and Arena 2 Standard Rental**

1 hours of set up time (decorating, DJ, etc.)
 A minimum of 2 hours of event time and a maximum of 6 hours
 1 hour clean up time
 All rental hours are consecutive